

SBS

Kühltechnik GmbH



COLD STORAGE AND DEEP-FREEZE CHAMBERS

EFFICIENT. HYGIENIC. ENERGY-SAVING.

SBS COLD STORAGE AND DEEP-FREEZE CHAMBERS

Specialities are our standard.

Quality and safety: we attach great importance to making our cold storage and deep-freeze chambers to exacting standards. Which is why we go to great lengths to ensure the hygienic storage of your chilled goods, such as by installing easy-to-clean surfaces. You can also rest assured that all safety-related aspects meet the recognised quality standards.

We believe it is important to take ecological aspects into account in the production of our cold storage and deep-freeze chambers. This is evident in our use of CFC-free insulating materials, which ensures efficient cooling processes despite using little energy.

Furnishings as required

- + Lighting, thermometer
- + Emergency call system
- + Special surfaces
- + Ramps



All components that make up SBS cold storage and deep-freeze chambers, whether ceilings, floor elements or doors, are systematically made to match.

Various layouts and temperature zones can be achieved by installing partition walls, such as a combined system with cold and deep-freeze sections.



HYGEINE+

Continuous coating ensures maximum hygiene.

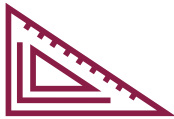

**100 MM WIDTH/DEPTH INCREMENTS
+ 150 MM HEIGHT INCREMENTS**

We construct and design exactly to your desired dimensions.



FRAMELESS DOORS

We give our projects a frame.
But not our doors.



ON-SITE SERVICE

Remote estimations? Not with us. We take measurements in person on site.



Strong performance, coolly calculated.

- + Cold storage and deep-freeze chambers for individual requirements
- + Flexible dimensions, optimum use of space
- + Short production times
- + Quick assembly, immediate commissioning
- + First-class quality and safety standards
- + Economic, energy-saving insulation
- + Robust equipment, long service life
- + Ecological profile and sustainability
- + On-site professional consultation: from one source.

THE STRUCTURE AND SYSTEM

Sophisticated system – perfected to the last detail.

By opting for an SBS cold storage or deep-freeze chamber, you can look forward to a highly flexible, individual product. In a nutshell: your cold storage or deep-freeze chamber is available in all sizes – and will be made to order.

A combined cold storage and deep-freeze chamber also offers flexible temperature options. Partition walls create a division with separate temperature zones, enabling different types of products to be stored.

We also offer flexibility with regard to dimensions, partitioning and insulation: whether you choose an insulation thickness of 80, 100, 120, 150 or 200 mm – your chilled goods should be stored appropriately, but of course by using as little energy as possible. Polyurethane rigid foam has the best insulating properties; according to DIN 4108, it is classified in thermal conductivity category 025. The volume weight is 40–45 kg/m³.

Exterior walls can be adapted to the ceiling height.

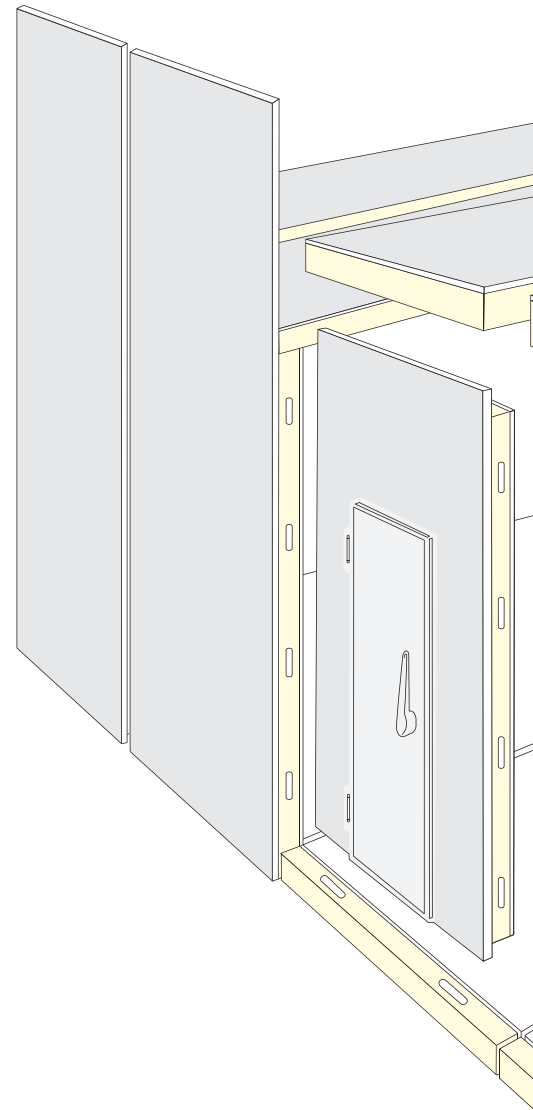

Optimum insulation is an elementary requirement in refrigeration engineering. A brief overview:

Insulation thickness	U-values	Recommended temperature difference
80 mm	0.27 W/Km ²	36 K
100 mm	0.22 W/Km ²	45 K
120 mm	0.18 W/Km ²	55 K
150 mm	0.14 W/Km ²	70 K
200 mm	0.11 W/Km ²	88 K

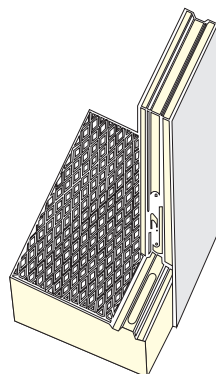

The wall is connected to the floor using a toggle-type fastener

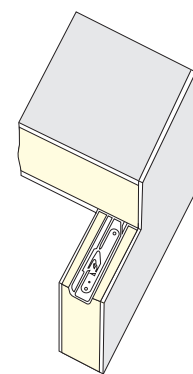

The wall is connected to the ceiling using a toggle-type fastener

We will be happy to advise you.

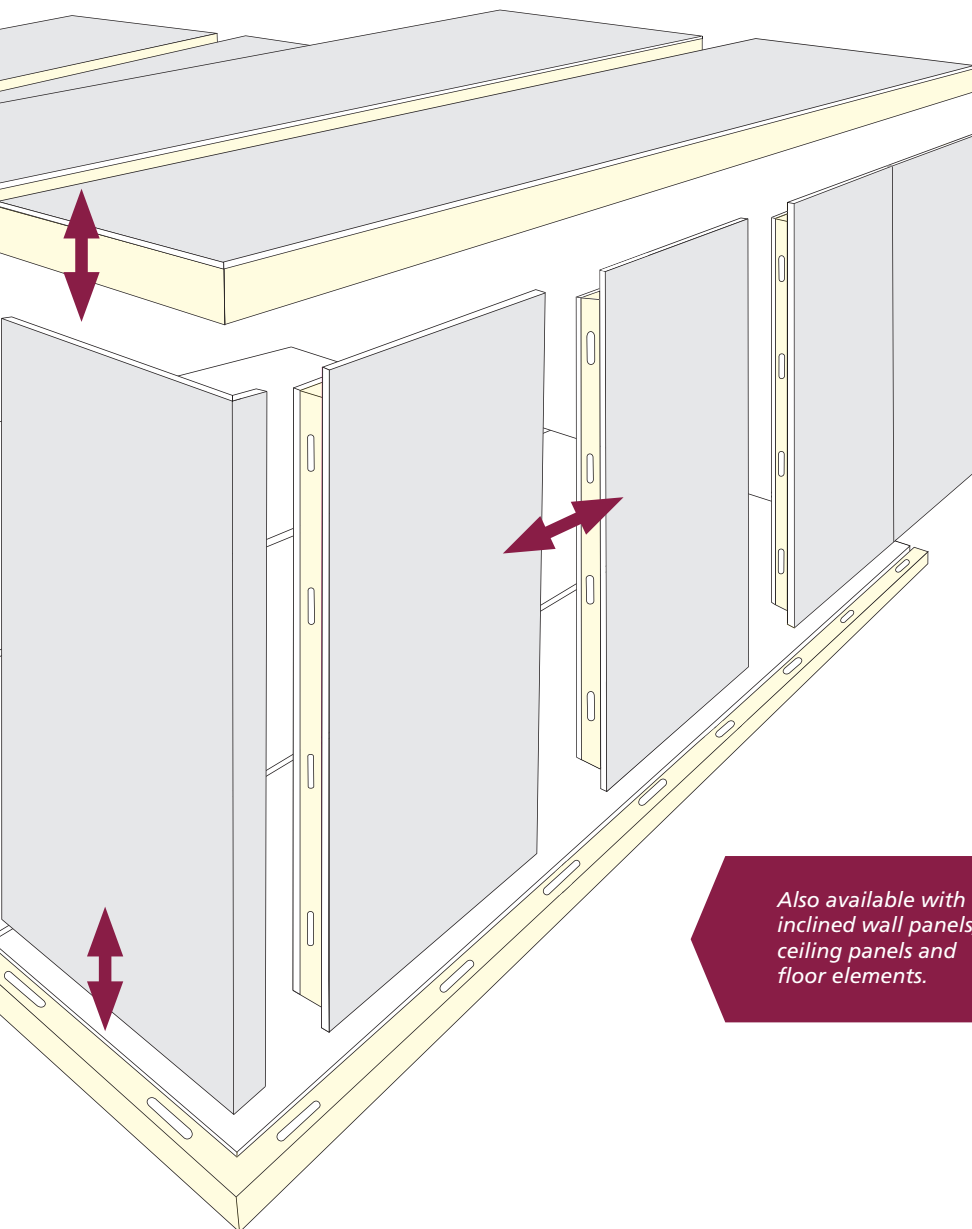

Also available with inclined wall panels, ceiling panels and floor elements.



When assembling our cold storage and deep-freeze chambers, individual elements are joined to each other securely using tongue and groove joints and foamed-in corrosion-resistant cam toggle-type fasteners. The door is usually locked from inside. In addition to being easy to use, robust and reliable, this system (figures on the left) offers a maximum degree of flexibility for developments and alterations, facilitating convenient spatial variation.

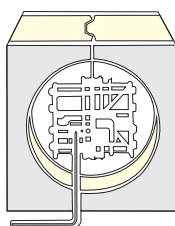

The wall is connected to the other wall using a toggle-type fastener

A close-up, slightly blurred photograph of a stack of white, rectangular insulation panels. The panels are stacked on top of each other, with some showing signs of wear and slight discoloration. The background is out of focus, showing more of the same panels and some dark, circular holes, possibly from a pallet or a similar structure. A red callout box is positioned on the right side of the image, containing white text.

Energy costs can be significantly reduced by insulating the cold storage chambers properly. We look forward to advising you.

WALL AND CEILING PANELS

With us, your chilled goods are in good walls.

The standard version features wall and ceiling panels that are furnished with galvanized thin sheet with a white synthetic coating (similar to RAL 9010) on the inside and outside. Other designs are possible, depending on your individual requirements:

- + Aluminium plate similar to RAL 9010
- + Stainless steel plate ground with 240 grain
- + Stainless steel plate linen texture
- + Stainless steel plate rolled blank 2B
- + Antibacterial coating
- + Special colour shades

The maximum self-supporting span of the ceiling panels depends on the insulation thickness. The span is 5.4 m with an insulation thickness of 80 mm, for example, or 6 m in the case of 150 mm insulation. With divided ceiling panels or larger spans, the panels are suspended from the customer's ceiling or a self-supporting steel construction using a special device.



Our understanding of care and cleanliness: Hygiene+

In our unique SBS Standard Hygiene+ range, wall panels and floor elements are mounted on the inside, meaning that no traverse joints are visible from outside.

The advantages:

- + Easy to clean
- + Easy-care and appealing surfaces

WIDE RANGE OF FLOORING

Safety on solid ground.

The design of the floor elements matches the wall and ceiling panels. They are additionally equipped with an anti-slip stainless steel surface as a standard feature, beneath which is a 15 mm pressure distribution plate. The thickness of the pressure distribution plate is adapted to suit thicker surfaces. All floors installed in SBS cold storage and deep-freeze chambers meet the highest hygiene requirements.

Standard floor surfaces

The standard floor has a pattern rolled bulb plate surface: material 1.4301 (anti-slip category R11), material thickness dependent on the load.



Floor element with a surface made of pattern rolled stainless steel-bulb plate, anti-slip category R11.



The floor surface with sandwich panels is available in two different thicknesses.

Stainless steel plate Material 1.4301	Rubber wheel load Load area 4 cm ² per rubber wheel	Distributed load
0.7 mm pattern rolled bulb plate Anti-slip category R11 or R12	1000 N	30 KN/m ²
1.5/2.0/3.0 mm pattern rolled bulb plate Anti-slip category R11 or R12	2500 N to 4000 N	40 KN/m ² to 50 KN/m ²

Sandwich panels	Rubber wheel load Load area 4 cm ² per rubber wheel	Distributed load
15 / 21 mm Anti-slip coating	3000 N bis 3500 N	40 KN/m ² bis 50 KN/m ²

Floor coating	Rubber wheel load Load area 4 cm ² per rubber wheel	Distributed load
Elastic, continuous polyurethane coating with scattered plastic chips to increase anti-slip resistance, for a temperature range of -30°C to +40°C	3000 N	50 KN/m ²

NOTE: Other floor coatings are available in different variations and with higher loads.

Floor surfaces for special requirements

As an option, we also supply our chambers with a rounded transition from the wall panel to the floor element and an antibacterial coating for wall panels and floor elements, taking the hygiene factor to even greater heights.



Elastic, continuous polyurethane coating, with hygienic ground radius on request. Suitable for a temperature range of -30°C to +40°C, quick and easy cleaning.



Ground radius: the rounded transition from the floor element to the wall panels takes the hygiene factor to even greater heights.



The welded stainless steel base tub offers considerable hygiene benefits and is easy to clean.

Individual floor structure

We look forward to advising you on your choice of floor design. Many variants are possible – the decision depends largely on the load requirements related to the intended use.



The use of foamed-in vacuum panels provides better insulation with a lower floor structure.

The use of recycled polyurethane as a pressure distribution plate results in a wood-free floor design.

Strong performance, coolly calculated.

- + Variety of designs, depending on application
- + Compliance with standardised anti-slip categories
- + Robust design, highly resilient
- + Hygienic, quick and easy cleaning
- + Individual consultation even at the planning stage

STANDARD DOORS

Tightly closed. Easy to open.

The doors of cold storage and deep-freeze chambers must close tightly, and be easy to use from both inside and outside. Conditions relating to hygiene, such as cleaning and maintenance, must of course also be met. Doors are made to the dimensions required.



Since the volume decreases when air is cooled, pressure equalization is required.



Robust door hinges made of high-quality materials (stainless steel / plastic) automatically lift the door leaf upon opening.



A robust press lever with an integrated profile cylinder lock ensures optimum closing. When the door is closed, it can be opened at all times from inside using an emergency release system.

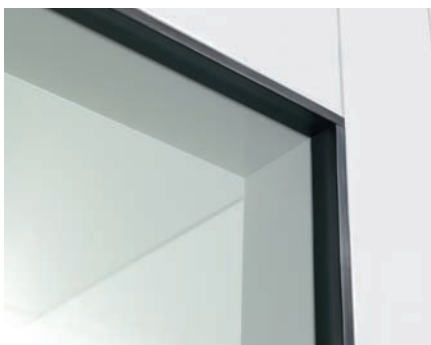

All doors for SBS cold storage chambers are equipped with a cold interruption profile. Frame heating can be retrofitted with little effort.

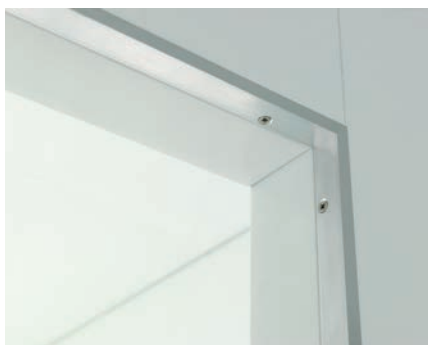

All doors for SBS deep-freeze chambers are equipped with a cold interruption profile and frame heating.



The hollow chamber seal attached to the door leaf is supplemented by a brush seal on the underside of the leaf, which is easy to clean and replace.



EASY ACCESS

The door can be positioned wherever required.

Each door is built into an element frame.

The door sill is equipped with a flush stainless steel plate.

SELF-CLOSING HINGED DOORS

Automatic closing, made simple.

Self-closing hinged doors, available for cold storage and deep-freeze chambers. In addition to the magnet handle bar, hinged doors are equipped with an innovative spring hinge that acts as a closing device, making sure the door closes automatically after opening.



Stainless steel handle bar with three-stage adjustable magnetic adhesive system. The operating force of the door can be adjusted optimally as needed.



Upward spring hinge that acts as a closing device. The hinge ensures that the door is closed automatically after opening.



Bolt lock

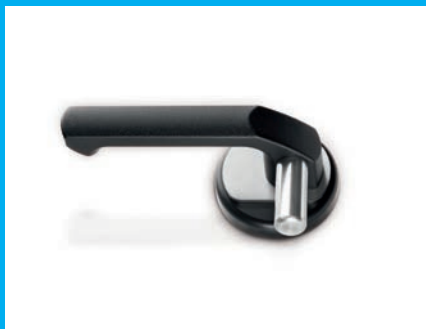

Emergency release system (inside)

Available as an option

+ As an option, doors are also available lockable with a bolt lock.

SLIDING DOORS

The right door for every wall.

SR Series sliding doors offer maximum flexibility and functionality, hygiene and economy. They are extremely reliable and versatile in any working environment. The SR8 is used for cold storage chambers and the SR12H for deep-freeze chambers.

The sliding doors are designed with hygiene in mind:

- + Exposed track
- + Sloping surfaces ensure adequate drainage
- + Designed for daily cleaning: corrosion-resistant and detergent-resistant

A range of surface finishes are available. Galvanised steel plate painted in a variety of RAL colours. Stainless steel matt brushed, circular matt or with longitudinal grinding.

All sliding doors, apart from those with a stainless steel finish, are fitted with a Thermotec flat frame in RAL 9002 as standard. These frames are covered with a stainless steel plate as standard.

The deep-freeze version (SR12H) is equipped with integrated, self-regulating frame heating for minimum energy requirements.

All sliding doors are also available with electric automation, meaning that they do not have to be opened manually.



FROM ONE SOURCE

Accessories and components for every application.

All chambers are also available with a viewing window. Type and size are adapted to requirements.



LIGHTING

You can also choose LED lighting to suit your chamber. Simply contact us.

Skirting protection

Is there a lot going on in and around the chamber? As an option, protect your chamber with our skirting protection.



Units

We are happy to offer you plug-in refrigeration units with a prefabricated aperture in the element. Wall or ceiling units, piggy-back units or in-wall units. We adapt the cooling unit to the room volume to ensure optimum cooling. Simply contact us.



Strip curtains

PVC strip curtains are often used as a low-priced, energy-efficient solution for door areas. They are ideal for low to moderate demands in cold storage and deep-freeze chambers.



PVC strip curtains:
inexpensive and energy-saving.

- + Metal parts made of aluminium
- + Width of plastic strips 200/300 mm, thickness either 2 or 3 mm
- + Can be installed below or behind the lintel
- + Optional: strip curtains made of a particularly cold-resistant material for operating conditions at temperatures between 0°C and -40°C

Ramps

Our ramps are made of stainless steel or aluminium and can be adapted in size to suit any requirement. Internal ramps are also available as an option.

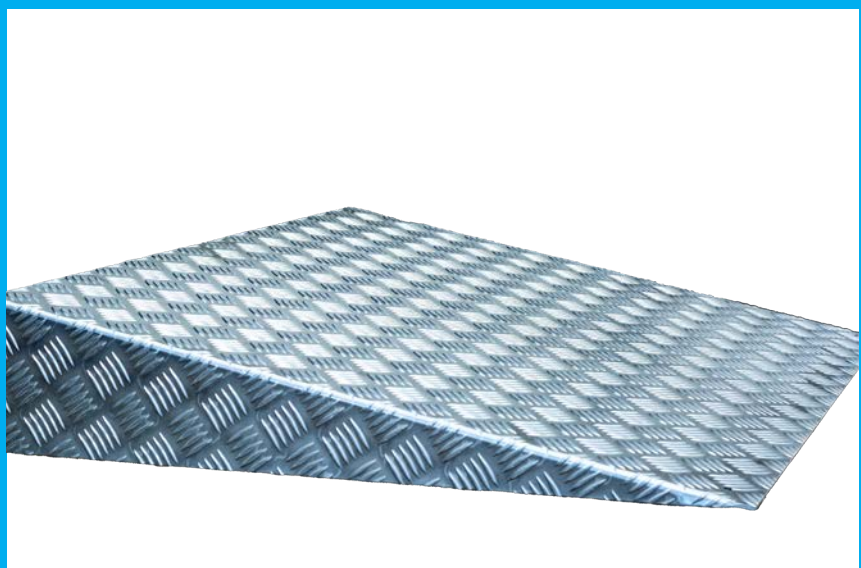

Note: More accessories available.

GLASS DOORS + SHELVES

Cool storage – attractively presented.



The goods are clearly visible behind insulated glass doors

Wherever chilled goods need to be presented attractively to promote sales, whilst saving on energy, glass doors with optimum insulating properties are the right solution, e.g. in petrol filling stations or drinks markets and supermarkets.

Glass doors are available in frame modules with anything from 1 to 5 doors. Naturally anodised aluminium door profiles and outer frames are available for door clear dimensions of 597 mm and 699 mm width and 1531 mm and 1731 mm height.

Our glass doors are hinged on the right as standard.

Strong performance, coolly calculated.

- + Promotional presentation of goods
- + Energy-efficient storage
- + Simple, user-friendly operation
- + Clear view, even at low temperatures
- + In combination with shelves: removal of goods is easy and convenient



Shelves are aligned to the widths of the glass doors, offering customers optimum access. The shelving system is filled from the rear. Other glass door designs are available on request.

Cold facts: glass doors for cold-storage chambers

- + Heated door frame
- + Hard double insulation glass for optimum insulation
- + Free of condensation with a maximum ambient temperature of +25°C, maximum relative air humidity of 70% and a temperature within the chamber of +2°C

Ice-cold facts: glass doors for deep-freeze chambers

- + Heated pane and door frame
- + Condensation-free view
- + Optimum insulation due to hard, heated, triple insulation glass
- + Free of condensation with a maximum ambient temperature of +25°C, maximum relative air humidity of 60% and a temperature within the chamber of -25°C



Shelves for glass doors in shops

- + Frame with sliding racks with adjustable tilt, as well as dividers and front panels
- + Neat, safe positioning of products
- + Rail for barcodes and price labels, clearly visible and easily removable
- + Various models matching the glass doors of SBS cold storage chambers
- + Variable number of vertical elements and sliding racks, depending on the model

We recommend the use of robust, high-quality processed shelves made of anodised aluminium or rust-proof stainless steel. Featuring seamless manufacture, smooth easy-to-clean surfaces and plastic end caps on the shelf supports, these systems meet the highest safety and hygiene requirements.

Strong performance, coolly calculated.

- + Available in either rust-proof stainless steel or a light-weight aluminium design
- + Flexible adjustment to existing room dimensions (also L- or U-shaped)
- + First-class workmanship, robust design
- + Shelf height individually adjustable at 150 mm intervals
- + Good stability, even on uneven floors, with use of screw feet
- + Extremely sturdy, resilient and robust
- + Quick to assemble, easy to clean



The height catch at 150 mm intervals enables the shelves to be arranged flexibly



Closed stainless steel shelf rest



Closed aluminium shelf rest



Stainless steel grid plate



Aluminium grid plate

Shelf rests

The load-bearing capacity of shelf rests is a decisive factor. Closed shelf rests or grid plates are used, depending on the individual area of application. Depending on dimensions, the shelf load can be up to 200 kg; the standard shelf load is 100 kg. A shelf bay can take up to 600 kg (bay load).

ALWAYS THE IDEAL SOLUTION

Cool heads, dedication with a passion.

Consultation & planning

Our team of reliable and motivated experts enjoy thinking outside the box to find the optimum solution for your requirements. We only start designing your cold storage or deep-freeze chambers once all of your individual requirements have been defined. We plan, organise and coordinate to ensure that you always maintain an overview.

Our success is based on reliability, promptness and expertise, and the dedication of our employees.

Service & maintenance

Cold storage and deep-freeze chambers by SBS are characterised by top quality and a long service life. Our products are low-maintenance and easy to clean. In the unlikely event of a problem, our service team will always be there to assist you.

Delivery & assembly

Carefully packed, complete and punctual: that's all we really need to say on the subject of delivery. And what about assembly? Prompt, clean and straightforward.

Production & quality control

Every SBS cold storage chamber is made to order in state-of-the-art conditions and in compliance with recognised quality standards, enabling us to meet customers' individual requirements precisely and in no time at all.

SBS – cool facts.

- + Professional full-range supplier of cold storage and deep-freeze chambers
- + Service-oriented philosophy
- + Dedicated, excellently trained and motivated team
- + Competent contact partners for individual custom-made products
- + Quality made in Germany





Service plus

Our strengths – your advantages:

- + Consultation by specialists
- + 80% individual customised solutions
- + Quick quotations (usually one hour after receiving an enquiry)
- + Short delivery times
- + Keen adherence to schedules
- + Absolutely reliable
- + Service with a guaranteed feel-good factor



Cold storage and deep-freeze chambers – made in Germany.

Since its foundation in 1997, SBS Kühltechnik GmbH has evolved into an innovative and high-performance expert in the development and production of cold storage and deep-freeze chambers. We will gladly develop a suitable solution for you too!

MORE INFORMATION

Scan QR code and find out more!



Distribution via authorised dealers only

